

Reference to geographic location 602.66' W142.88  
 1002' 7.86' S100.00' E0.00'  
 573.80' S0.00' E0.00'  
 1000.00' S0.00' E0.00'

Corner  
 Station  
 1418.11

# Stage Road

## Penniman Road



**Legend**  
 Stone wall  
 Utility pole

Drawn by: C. E. Rollins

Revised: 3/02/2016 Wetland edge  
 Revised: 1/30/2016 POTENTIAL WELL SITE

**Rollins Land Survey**  
 1216 Rt. 124 P.O. Box 291  
 Plainfield, NH 03781

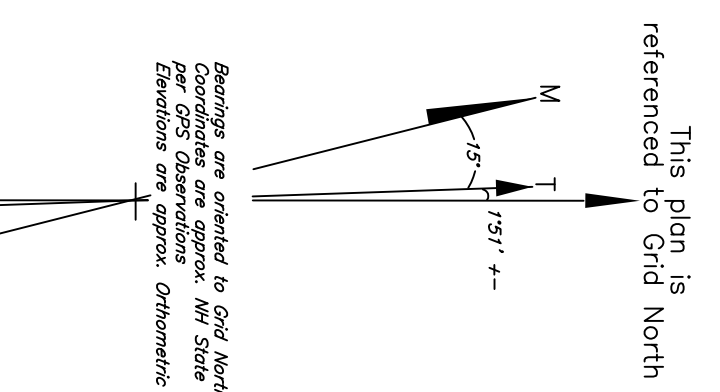

Bearings are related to Grid North  
 Coordinates are approx. NH State Plane  
 Elevations are approx. Orthometric Heights (WADSW)

For County Use

Site Plan  
**Highway Department**  
 Town of Plainfield, NH

One inch = 30 feet

Located on Stage Road  
 in the Town of Plainfield  
 in the County of Sullivan  
 State of New Hampshire, Date: Aug. 27, 2015

Surveyed for:  
 Town of Plainfield

Subject property is described in deed  
 1236/62...  
 of the Sullivan County Registry of Deeds.  
 Owner of record according to town records is:  
 Town of Plainfield  
 and is listed as:  
 Map 253-Lot 1  
 on the town tax map.

Project 1638-4