

RIGID INSULATION
FILLER
TO ALIGN JOINT
WITH OUTER HALF
OF GARAGE
DOOR
THICKNESS.)

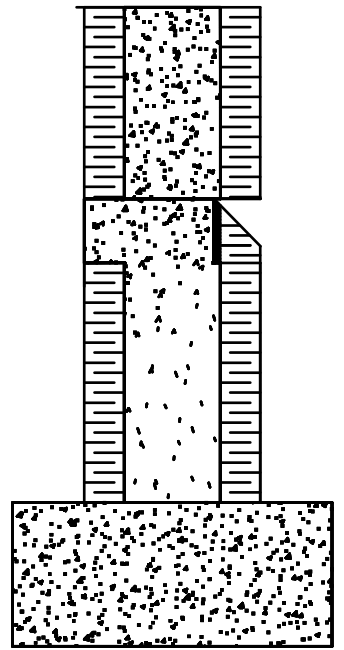

1. WALL POUR SET-UP AT GARAGE DOOR DROP
FINISH SURFACE TO MATCH TOP OF SLAB
AND SLOPED FOR DRAINAGE IF DESIRED
REBAR COULD BE ADDED IF ANALYSIS
OR EXPERIENCE INDICATED

2. WALL FOAM CUTBACK
DURING PREP FOR SLAB POUR

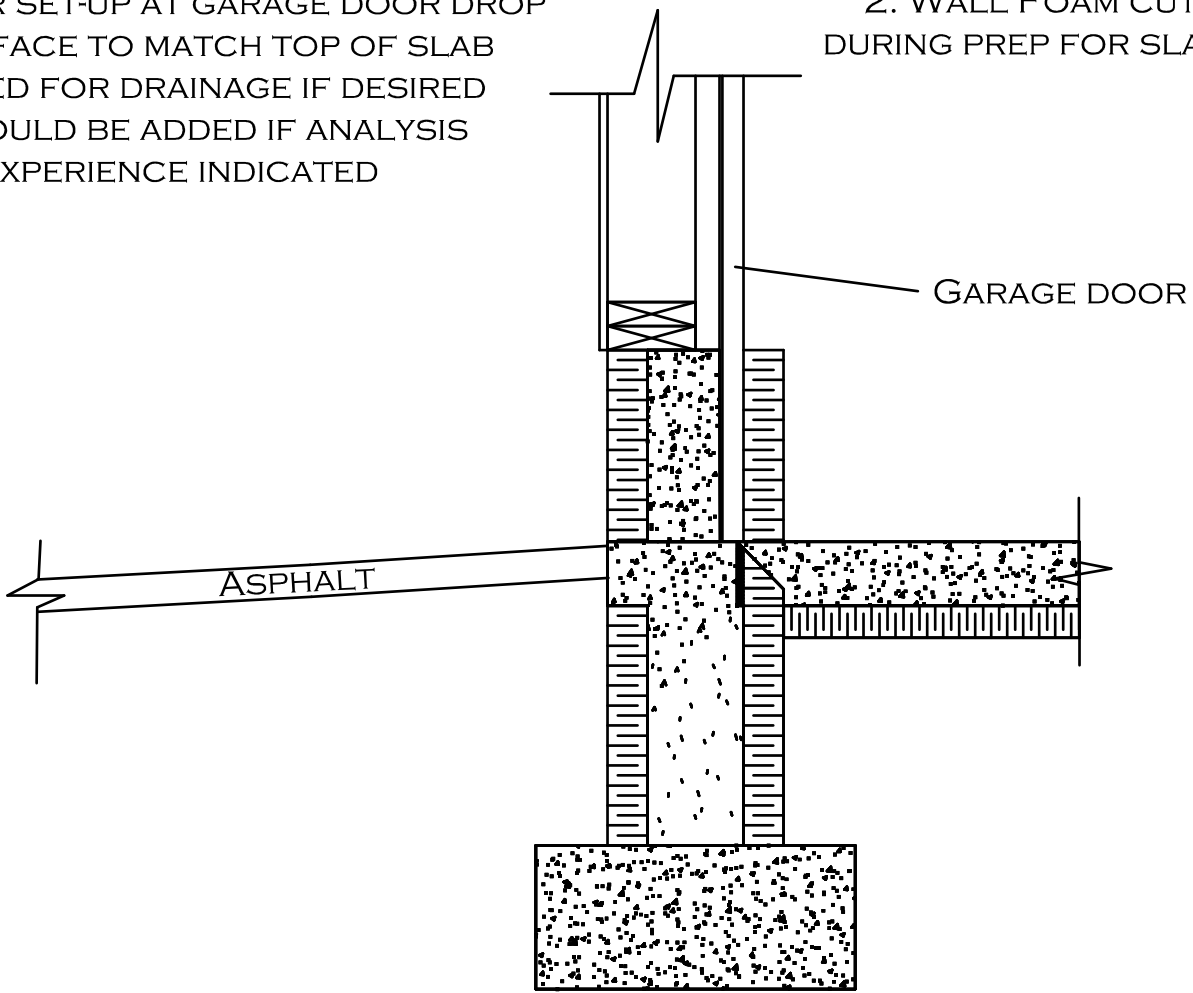

3. FINAL
AESTHETICALLY SIMILAR
(CONCRETE SHOWS IN DOOR OPENING)
STANDARD TRANSITION TO ASPHALT OR GRAVEL
DURABLE THERMAL BREAK
WITH SOME R VALUE AT SLAB EDGE