

2018-5-15  
15 Ladies

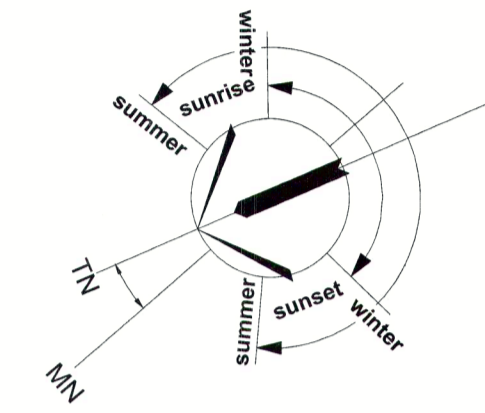

- Existing garage wall with new exterior continuous and dense packed cellulose insulation
- New interior wall
- Existing wall to be removed
- Existing exterior wall
- Existing interior wall

668 sf renovated garage space  
162 sf renovated workroom space  
830 sf total

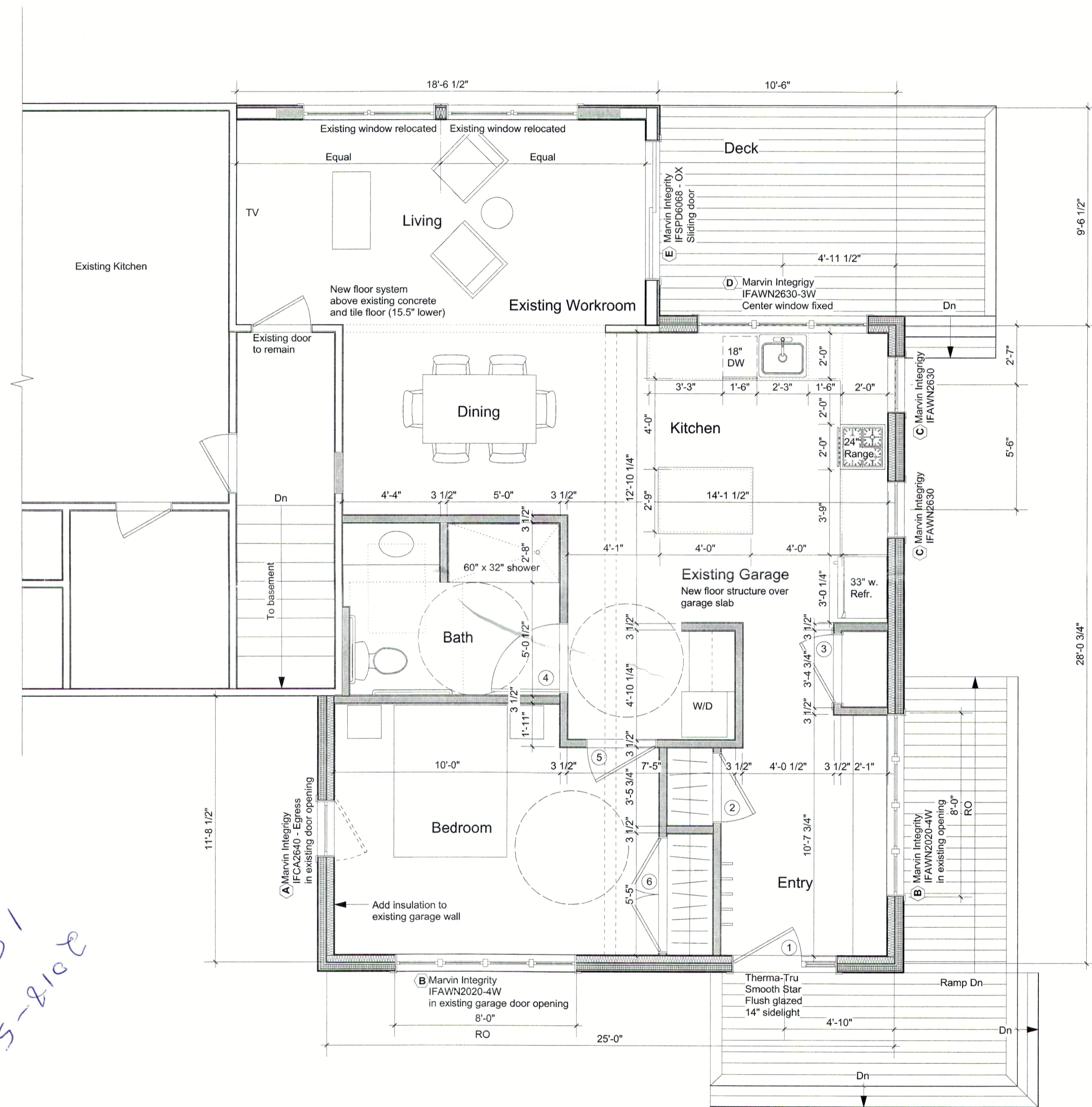
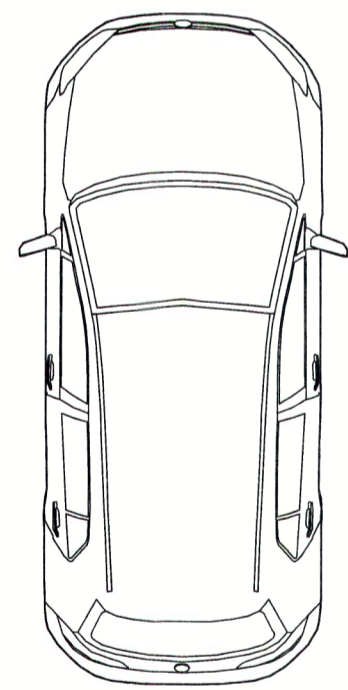

### Marshall-Teehan Garage Renovation

Jill Marshall and Sean Teehan  
15 Ladieu Road  
Plainfield, New Hampshire

H. Sloane Mayor  
Architect  
11 Bank Street  
Studio 306  
Lebanon, NH  
603-667-0303

### 1st Floor Plan

1/4" = 1'-0"

July 22, 2018