

TOWN OF PLAINFIELD ZONING AND BUILDING PERMIT APPLICATION



Property Owner:

Name: Cori Tebbetts Phone: 603-443-1311

Street: 943 Stage Road Email: cori.stebbins@gmail.com

City State Zip: Plainfield, NH 03781

Project: Permit Type: (Check one) Building Zoning

Street Address: 943 Stage Road

Tax Map: 254 Lot Number: 27 Lot Acreage: Zoning District:

Proposed project distances to property lines (in feet): Front: Rear: Side: Side:

State Approved Septic Design #: Driveway Permit #:

Please provide a written description of the project including appropriate dimensions: Replacing 16'3" load-bearing wall between the kitchen and the living room with 3, 12" LVL beams to create a drop ceiling and using 3 2x6s to support the beam.

Contractor Information:

Builder:	Electrician:	Plumber:
Name: <u>Michael Tebbetts</u>	Name: <u> </u>	Name: <u> </u>
Phone: <u>802-356-4456</u>	Phone: <u> </u>	Phone: <u> </u>

Applicant Signature: Cori Tebbetts Date: 6/9/19

Required Attachments:

Please provide a copy of plans detailing the project. Hand-drawn plans can be used if necessary. Permits cannot be issued without receipt of the proper fee. If you are unsure of the amount due or have any questions about your application, contact the town office (603-469-3201).

TOWN USE: Current Use: Yes / No ZBA: Yes / No PB: Yes / No

BOARD OF SELECTMEN ACTION

Approved Denied

Permit #: 19-38 Date: 6/5/19

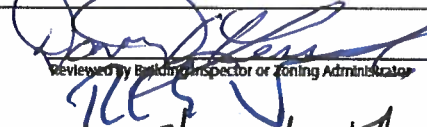
 Reviewed by Building Inspector or Zoning Administrator
Thomas W. Smith
Eric R. B...

Level, Floor: Drop Beam

Current Solution: 2 piece(s) 1 3/4" x 14" 2.0E Microllam® LVL

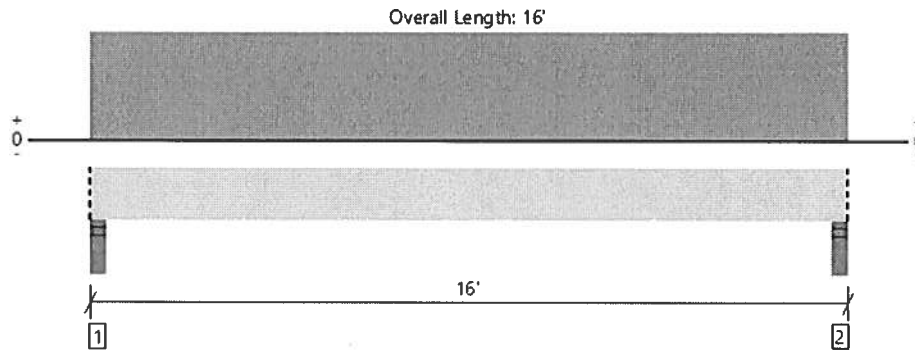

All locations are measured from the outside face of left support (or left cantilever end). All dimensions are horizontal.

Design Results	Actual @ Location	Allowed	Result	LDF	Load : Combination (Pattern)
Member Reaction (lbs)	5930 @ 2 1/2"	5950 (4.00")	Passed (100%)	--	1.0 D + 1.0 S (All Spans)
Shear (lbs)	4818 @ 1' 6"	10707	Passed (45%)	1.15	1.0 D + 1.0 S (All Spans)
Moment (Ft-lbs)	22502 @ 8'	27897	Passed (81%)	1.15	1.0 D + 1.0 S (All Spans)
Live Load Defl. (in)	0.458 @ 8'	0.519	Passed (L/408)	--	1.0 D + 1.0 S (All Spans)
Total Load Defl. (in)	0.667 @ 8'	0.779	Passed (L/280)	--	1.0 D + 1.0 S (All Spans)

System : Floor
 Member Type : Drop Beam
 Building Use : Residential
 Building Code : IBC 2015
 Design Methodology : ASD

All Product Solutions			
Depth	Series	Piles	Wood Volume
14"	1 3/4" 2.0E Microllam® LVL	2	98.00

The purpose of this report is for product comparison only. Load and support information necessary for professional design review is not displayed here. Please print an individual Member Report for submittal purposes.

ForteWEB Software Operator	Job Notes
dan morris apex (904) 545-5761 dan.morris@apextechnology.com	



Cori Stebbins <cori.stebbins@gmail.com>

Beam question

3 messages

Cori Stebbins <cori.stebbins@gmail.com>
To: Darcy Stebbins <darcy.r.stebbins@gmail.com>

Tue, Jan 22, 2019 at 3:11 PM

Hey, sis!
Hope you're doing well! Haven't talked in a while.

Mike and I had a question. Is there any way we can make the beam shorter and wider to come down like 8" rather than 14"?

Thanks for your help again.
Love ya!
Cori

Darcy Stebbins <darcy.r.stebbins@gmail.com>
To: Cori Stebbins <cori.stebbins@gmail.com>

Thu, Jan 24, 2019 at 7:26 AM

[Redacted]
truss and structural head said "I think you could add a ply and go to 12", but no way to go to 8".

hope that helps.

LOVE YA!
[Quoted text hidden]
--
Darcy Stebbins

Cori Stebbins <cori.stebbins@gmail.com>
To: Darcy Stebbins <darcy.r.stebbins@gmail.com>

Thu, Jan 24, 2019 at 8:24 AM

LOL Thanks! It's at least a little better.

[Redacted]
Love ya too. [Redacted] 😊🙄
Some weird emojis on google...
[Quoted text hidden]

Current Layout – 943 Stage Road

